

NEBRASKA BIOCONTAINMENT PATIENT CARE UNIT

Located on the seventh floor of the Nebraska Medical Center's University Tower, the 4,100-square-foot facility was commissioned by the U.S. Centers for Disease Control and Prevention and opened in 2005. The "dirty side" on the map is where patients are treated and gear is considered contaminated. The "clean side" is where the uncontaminated gear and staff are.

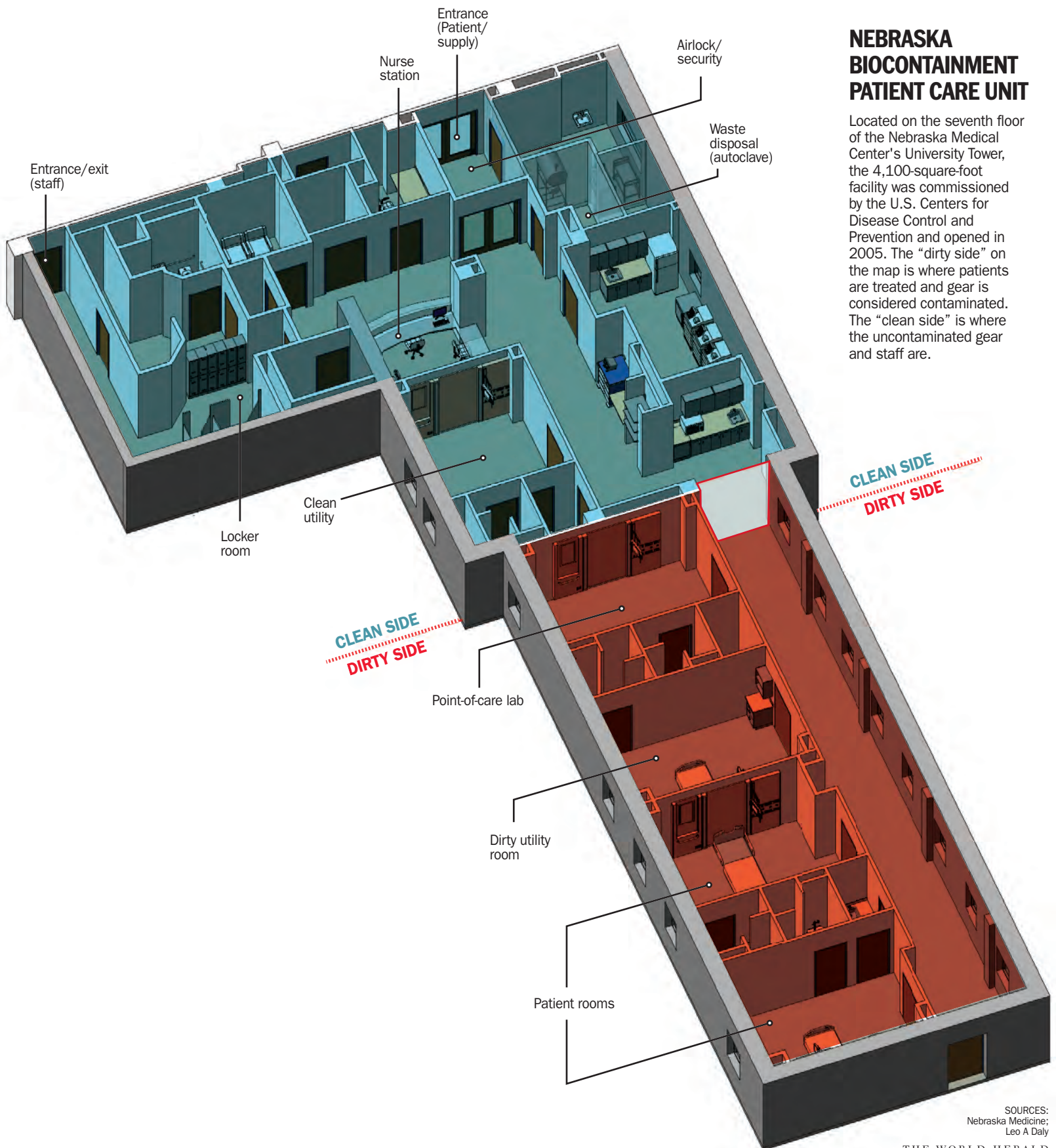

SOURCES:
Nebraska Medicine;
Leo A Daly